



AVAILABLE SPACE: 4,010 RSF 3,722 USF

**Retail Space (former restaurant)**  
**221 S. Washington Street**  
**Naperville, IL 60540**  
**FOR LEASE**



**CONTACT:** NOEL ESCALONA [nescalona@escalonare.com](mailto:nescalona@escalonare.com) 847.460.0096  
JOE CONROY [joeconroy450@gmail.com](mailto:joeconroy450@gmail.com) 224.216.9817

This document has been prepared solely for informational purposes. While the information contained herein is from reliable sources, it has not been independently verified. The document is provided subject to errors, omission and changes in information.



# Available Retail Space

221 S. Washington Street  
Naperville, IL 60540



This document has been prepared solely for informational purposes. While the information contained herein is from reliable sources, it has not been independently verified. The document is provided subject to errors, omission and changes in information.





1 **FINISHES - EAST ELEVATION PROPOSED**  
1/4" = 1'-0"

**EXTERIOR FINISHES LEGEND**

- A THIN BRICK: 365 SCHOOLHOUSE RED FLASHED
- B THIN BRICK: 220 COURTYARD
- C STONE: ADAIR "MEDIUM DRESSED FLEURI"  
8" x 24"
- D STONE: ARRISCRAFT "RENAISSANCE - CAFE"  
SMOOTH" 8" x 24"
- E AWNING: "BLACK CANVASS" SUNBRELLA OR EQUAL

**PROPOSED WEST ELEVATION**

221 S WASHINGTON ST

221 S WASHINGTON ST,  
NAPERVILLE, IL 60540

DATE 02.10.2025

REV# #1

PROJ # 2414.001.000

SHEET SD-010825

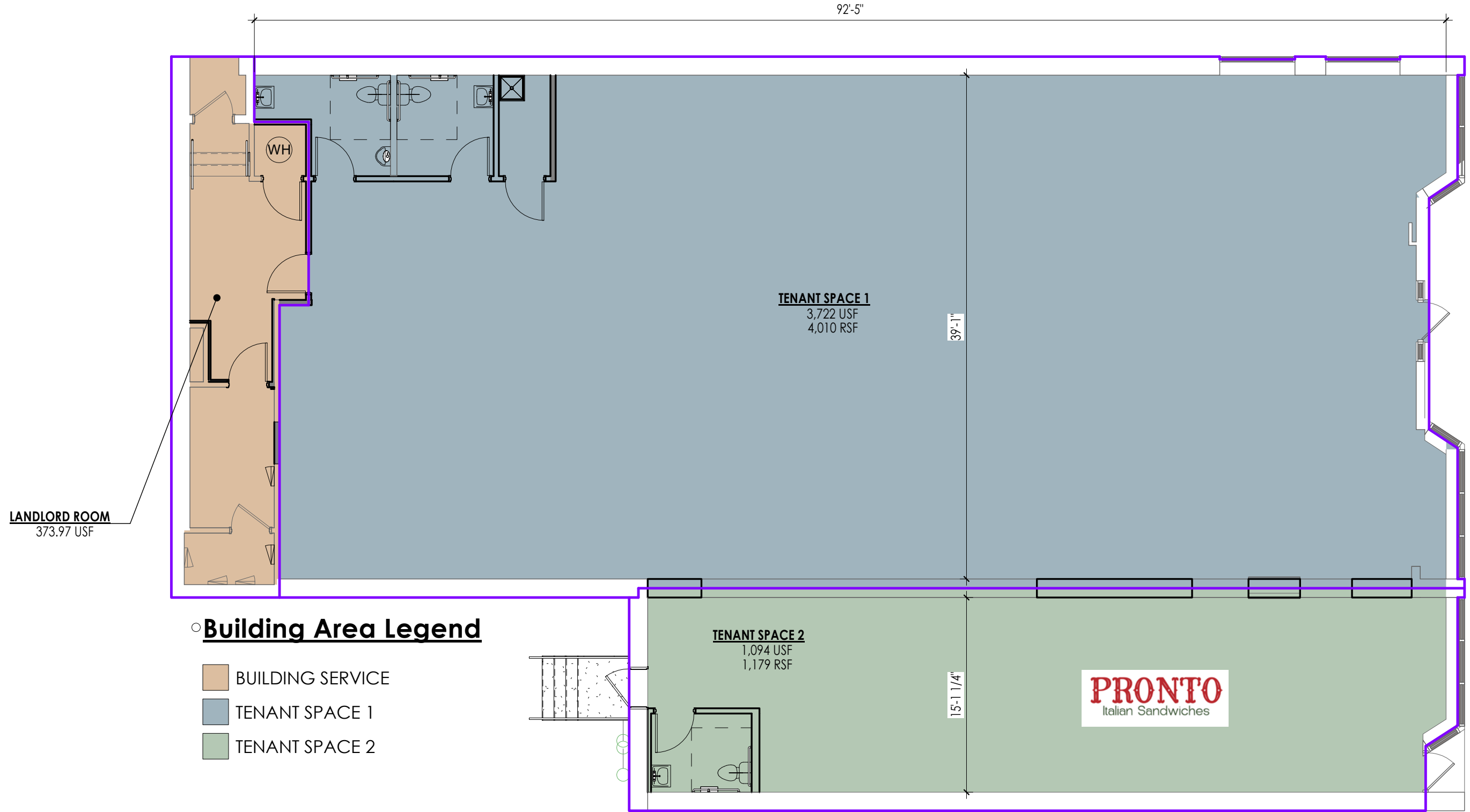

# PROPOSED DEMISING WALLS

1/8" = 1'-0"



## PROPOSED DEMISING WALLS

221 S WASHINGTON ST

221 S WASHINGTON ST,  
NAPERVILLE, IL 60540